

IMPORTANT SAFETY INSTRUCTIONS

WARNING: To reduce risk of burns, fire, electric shock, or injury to persons:

- READ INSTRUCTIONS BEFORE USING
- BURNS WILL RESULT FROM IMPROPER USE
- NEVER REMOVE COVERS

IMPORTANT: Patients using a pacemaker should consult a physician prior to use.

This appliance should never be left unattended when plugged in. Unplug from outlet when not in use, and before putting on or taking off parts.

Close supervision is necessary when this unit is used by, on, or near children, invalids, or disabled persons.

Use this unit only for its intended use as described in this manual. Do not use attachments not recommended by the manufacturer. Keep the cord away from heated surfaces. Do not use outdoors.

Do not operate where aerosol (spray) products are being used or where oxygen is being administered.

Temperatures sufficiently high to cause burns may occur regardless of the control setting. Do not use on an infant or on a sleeping or unconscious person. Do not use on insensitive skin or on a person with poor blood circulation. Check the skin in contact with the heated area of the appliance.

Never operate this appliance if it has a damaged cord or plug, if it is not working properly, if it has been dropped or damaged, or dropped into water. Return the appliance to a service center for examination and repair.

To disconnect, turn all controls to the off position, then remove plug from outlet.

WIRING DIAGRAM

System Connection Diagram

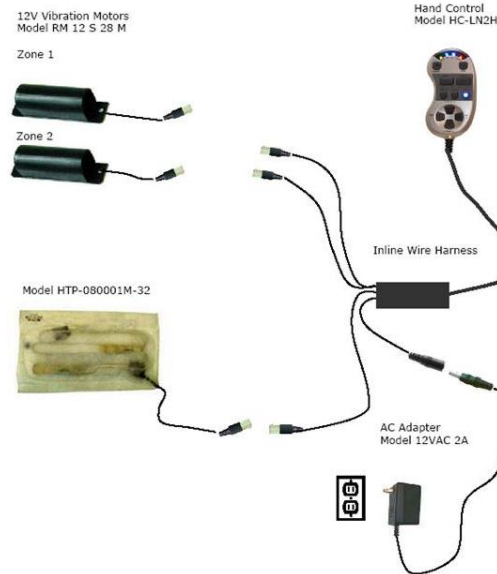

DANGER - TO REDUCE RISK OF ELECTRIC SHOCK:

Always unplug the unit from the electrical outlet immediately after using.

Do not reach for an appliance that has fallen into water. Unplug immediately.

Never use pins or other metallic fasteners with this appliance.

Carefully examine the covering before each use. Discard the appliance if the covering shows any sign of deterioration, such as checking, blistering, or cracking.

Keep dry - Do not operate in a wet or moist environment.

TROUBLESHOOTING GUIDE

Symptoms	Possible Causes/Solutions
NO POWER	<p>Microprocessor Malfunction: Unplug unit, wait 30 seconds, then plug back in.</p> <p>Unit plugged into switched outlet or bad outlet: Verify outlet is working and that switch is on if it is a switched outlet.</p>
MOTORS/HEAT NOT WORKING	<p>Microprocessor Malfunction: Unplug unit, wait 30 seconds, then plug back in.</p> <p>Loose/unconnected wires: Verify all motor/heat pad connections.</p>

Operational Notes:

- Use only the power supply furnished with the unit.
- If system is accidentally unplugged while running, leave unplugged for 30 seconds before plugging in again.

SAVE THESE INSTRUCTIONS

OPERATING INSTRUCTIONS

Massage- Press POWER or either ZONE key to turn Massage ON. Press again to turn Massage OFF.

Timer- Press and hold POWER key to change timer from 20 to 30 mins (Green light indicates 20min, Red light indicates 30 mins)

Heat- Press HEAT key to turn heat ON high (Red light). Press again to turn heat OFF. Press and hold HEAT key to turn heat to LO setting (Blinking Red light)

Zone- Press Zone 1 or 2 keys to turn either zone ON or OFF

Select / Wave / Pulse- Press Select, Wave or Pulse keys to choose Massage type

Intensity Up/Down- Press up or down keys to increase or decrease Massage intensity

Speed +/- Press + or - keys to increase or decrease the Massage speed (PULSE and WAVE modes only)

POWER/ZONE
& HEAT



Tranquil-Ease®
Model HC-LN2H

SELECT/PULSE &
WAVE display

DISPLAY FUNCTIONS

POWER display – Light indicates that power is on or off.

ZONE display – Light indicates what massage zone is selected.

HEAT display – Light indicates heat is on or off.

SELECT/PULSE/WAVE display - Lights indicate which massage type is selected.

HC-LN2H USER GUIDE



N19 W6723 Commerce Court
Cedarburg WI 53012
PH: 262-375-1011
FX: 262-375-1010
www.raffel.com