

# OPERATING INSTRUCTIONS

## TURN MESSAGE ON

Press any of the following keys:  
POWER/SELECT/WAVE/PULSE/ZONE 1/ZONE 2

## TURN MESSAGE OFF

Press and release POWER key

### **Note:**

Zones 1 & 2 (BLUE LEDS) will now be active (ON). By default the 3:00 and 9:00 blue LEDS in POWER light ring will be lit to indicate 15 MIN timer, to change it to a 30 MIN timer, press and hold the POWER button for approximately one second. The 12:00 AND 6:00 LEDS in the POWER light ring will light as well.

## ZONE KEYS

Press ZONE 1 to turn ZONE 1 OFF. The blue LED and the ZONE 1 message motor is now off. Press again to turn ON. Press ZONE 2 to turn ZONE 2 ON or Off, the same as above.

## SELECT / WAVE / PULSE KEYS

**SELECT** = Motors will run steady mode  
**WAVE** = Motors will run alternating between Zone 1 & 2  
**PULSE** = Zones 1 & 2 operate simultaneously

**Note:** In SELECT mode the speed key will be inoperative.

## SPEED AND INTENSITY KEYS

**INTENSITY +/-** = Changes the RPM of the motors.  
**SPEED +/-** = Changes the rate of the motors wave or pulse mode.

## HEAT KEY

Press and release the key to turn on the HI setting, (STEADY RED LIGHT RING). Press and hold to turn heat on low setting. (FLASHING RED LIGHT RING). Press and release to turn heat off.

## Tranquil-Ease® Model HC-6122



## HAND CONTROL FUNCTIONS

**HEAT LED RING** – Indicates heat level setting.

**SPEED/INTENSITY KEYS** – Controls speed or intensity of motors.

**ZONE 1 & 2 KEYS AND LEDS**– Indicates the massage zone that is active.

**POWER LED RING** - Indicates timer setting.

# TROUBLESHOOTING GUIDE

Symptoms	Possible Causes/Solutions
NO POWER	<b>Microprocessor Malfunction:</b> Unplug unit, wait 30 seconds, then plug back in. <b>Unit plugged into switched outlet or bad outlet:</b> Verify outlet is working and that switch is on if it is a switched outlet.
MOTORS/HEAT NOT WORKING	<b>Microprocessor Malfunction:</b> Unplug unit, wait 30 seconds, then plug back in. <b>Loose/unconnected wires:</b> Verify all motor/heat pad connections.

## Operational Notes:

- Use only the power supply furnished with the unit.
- If system is accidentally unplugged while running, leave unplugged for 30 seconds before plugging in again.

**SAVE THESE INSTRUCTIONS**

## IMPORTANT SAFETY INSTRUCTIONS

**WARNING:** To reduce risk of burns, fire, electric shock, or injury to persons:

- READ INSTRUCTIONS BEFORE USING
- BURNS WILL RESULT FROM IMPROPER USE
- NEVER REMOVE COVERS

**IMPORTANT:** Patients using a pacemaker should consult a physician prior to use.

This appliance should never be left unattended when plugged in. Unplug from outlet when not in use, and before putting on or taking off parts.

Close supervision is necessary when this unit is used by, on, or near children, invalids, or disabled persons.

Use this unit only for its intended use as described in this manual. Do not use attachments not recommended by the manufacturer. Keep the cord away from heated surfaces. Do not use outdoors.

Do not operate where aerosol (spray) products are being used or where oxygen is being administered.

Temperatures sufficiently high to cause burns may occur regardless of the control setting. Do not use on an infant or on a sleeping or unconscious person. Do not use on insensitive skin or on a person with poor blood circulation. Check the skin in contact with the heated area of the appliance.

Never operate this appliance if it has a damaged cord or plug, if it is not working properly, if it has been dropped or damaged, or dropped into water. Return the appliance to a service center for examination and repair.

To disconnect, turn all controls to the off position, then remove plug from outlet.

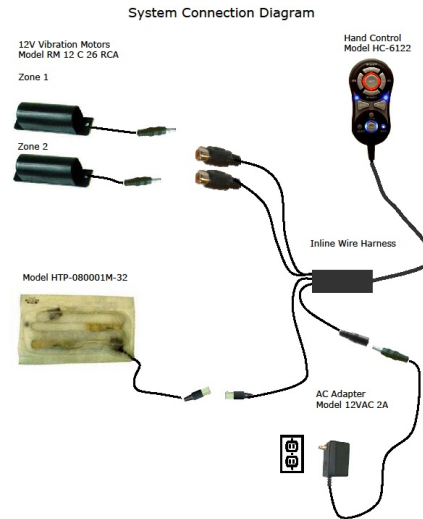

## DANGER - TO REDUCE RISK OF ELECTRIC SHOCK:

**Always unplug the unit from the electrical outlet immediately after using.**

**Do not reach for an appliance that has fallen into water. Unplug immediately.**

**Never use pins or other metallic fasteners with this appliance.**

**Carefully examine the covering before each use. Discard the appliance if the covering shows any sign of deterioration, such as checking, blistering, or cracking.**

**Keep dry - Do not operate in a wet or moist environment.**

## HC-6122 USER GUIDE



**RAFFEL SYSTEMS**  
N19 W6723 Commerce Court  
Cedarburg WI 53012  
PH: 262-375-1011  
FX: 262-375-1010  
[www.raffel.com](http://www.raffel.com)